

# Dimensions and technical specification of the normally closed (NC) solenoid valves type EV

Type	Connections			Nominal seat size Ø [mm]	Kv [m <sup>3</sup> /h]	Operating principle	Openig Pressure Differential [bar]		TS [°C]		PS [bar]	Dimensions [mm]							Category PED 97/23/CE
	SAE Flare	ODS					minOPD	MOPD 9W a.c.	min	max		H <sub>1</sub>	H <sub>2</sub>	H <sub>3</sub>	L <sub>1</sub>	L <sub>2</sub>	L <sub>3</sub>	Screws	
		[in.]	[mm]																
EV32MM	1/4"	-	-	3,3	0,26	Direct Acting	0	25	-35	105	45	79	66	39	65	46	58	M4	Art. 3.3
EV33MM	3/8"	-	-												70				
EV32S	-	1/4"	-												122				
EV33S	-	3/8"	-												124				
EV3M10S	-	-	10																

**APPLICATION:** Solenoid valves are suitable for fluids of Group II, as defined in Article 9, Section 2.2 of Directive 97/23/EC, therefore not toxic, not inflammable and not explosive fluids; to this macro Group belong also the refrigerant fluids listed and classified L1 in Annex E of standard EN 378-1:2003.

**CONSTRUCTION:** The body and the cover are made of hot-forged brass EN 12420 -CW617N and the welding connections, are realized with copper tube EN 12735-1-Cu-DHP. All springs are made of austenitic stainless steel AISI 302 and the enclosure of the armature is made of austenitic stainless steel AISI 305 - 1.4303; The ferritic stainless steel AISI 430F of armature, the chloroprene gasket between body and cover and the EPDM O rings disposed under and over the coil, assure an effective protection of the valve from oxidant agents.

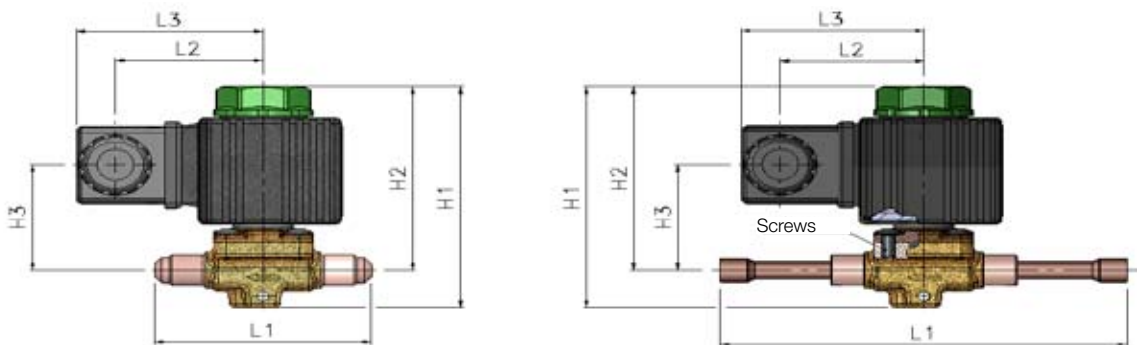

Description	GENERAL SPECIFICATION OF COILS						
	Coil Type	Voltage A.C. [V]	Voltage D.C. [V]	Voltage tolerance [%]	Frequency [Hz]	Connections	Degree of protections
The coils series KMA are pre-arranged for an AC power supply and they are used <b>only as normally closed valves</b> . The terminals of coils consist of an earth connection faston plus two faston line connections in order to be matched with connector DIN43650.	KMA2	24	-	±10	50/60	DIN43650	IP65(1) EN60529
	KMA4	110	-				
	KMA6	220/230	-	+6/-10			
	KMA7	240	-	±10			

(1) This is the degree of protection guaranteed by coil&plug system DIN43650 assemblies with the appropriate gaskets in equipment, according to EN 60529.

**ELECTRIC TYPE APPROVAL:**  
All coils are manufactured according to Low Voltage Directives EC 73/23 and EMC Directives 2004/108/CE

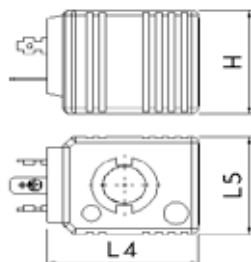

ELECTRICAL SPECIFICATION AND DIMENSIONS OF COILS						
Coil type	Voltage A.C. [V]	Voltage D.C. [V]	Consumptions at 20°C at working [mA]	Dimensions [mm]		
				L <sub>4</sub>	L <sub>5</sub>	H
KMA2	24	-	971	48	36	39
KMA4	110	-	150			
KMA6	220/230	-	87			
KMA7	240	-	89			